

Quick Start Guide

P10

v1.0, Jan 2024

Copyright © 2024 Point Mobile Co., Ltd. All rights reserved.

Point Mobile Co., Ltd. is the designer and manufacturer of mobile handheld devices.

The Point Mobile logo is a registered trademark and symbol of Point Mobile Co., Ltd.

Features and specifications are subject to change without prior notice.



Device Parts

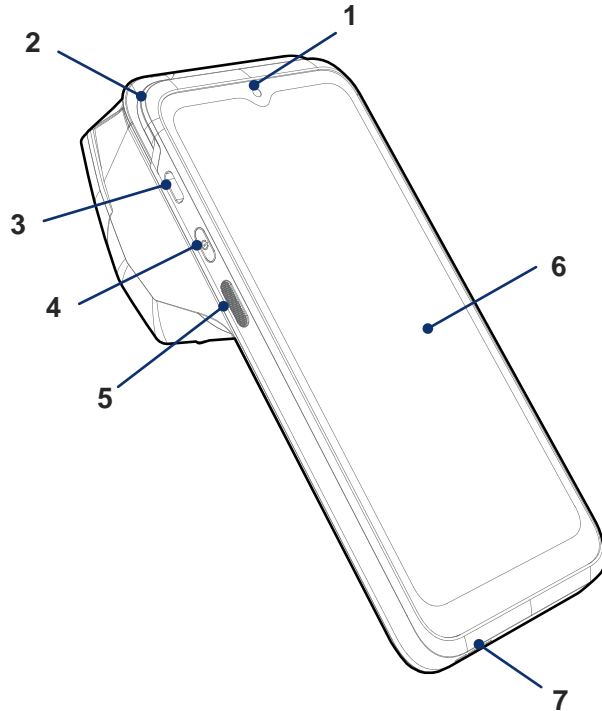

- 1. Front camera
- 2. Magnetic stripe reader
- 3. USB connector
- 4. Power button
- 5. Scan button
- 6. Touch Screen
- 7. Speaker

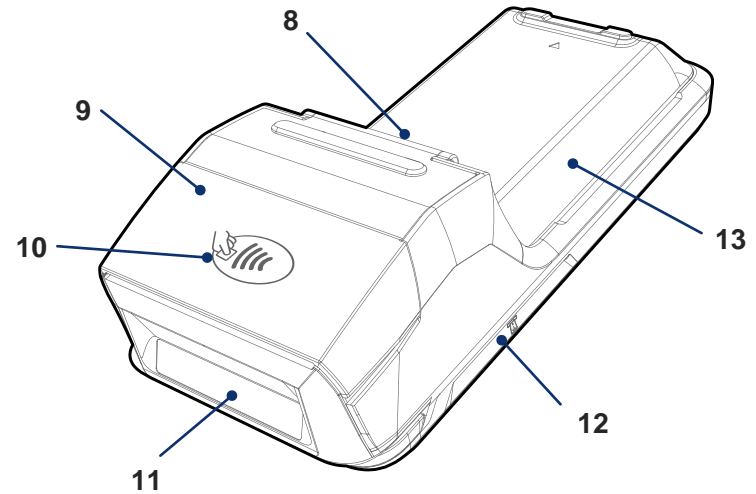

- 8. Rear I/O connector
- 9. Thermal printer
- 10. NFC tagging area
- 11. Scanner
- 12. IC card reader
- 13. Battery cover

Product Standard Accessories

- P10 (with Battery pack)
- Power adapter
- USB type C cable
- LCD protection film
- Quick guide

Battery Replacement

Insert Battery

1. Slide the battery cover down to open.
2. Plug the battery cable into the port.
3. Place the battery into the battery slot.
4. Align the battery cover, and slide it to the end.

Remove Battery

1. Slide the battery cover down to open.
2. Take out the battery from the slot.
3. Hold the end of the cable (white-colored part) and gently unplug it.

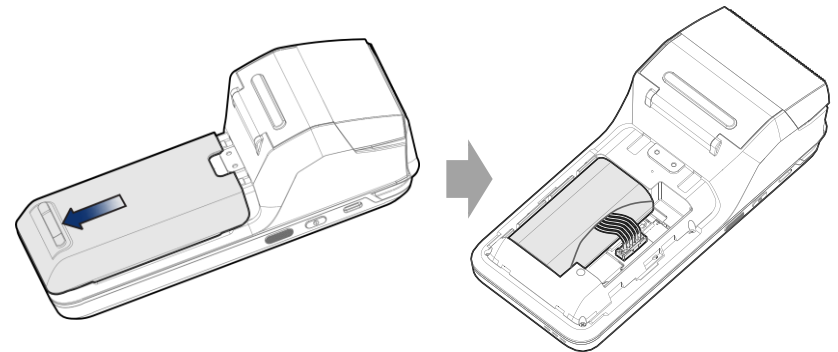

Paper Roll Installation

Paper roll (Thermal paper) recommendation

Width	58mm
Diameter	40mm

Install a paper roll

1. Pull the both sides of the printer cover to open.
2. Put the paper roll into the printer in the correct orientation.

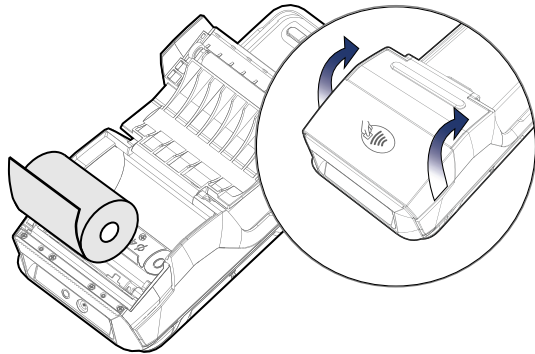

3. Close the printer cover firmly. The end of the paper roll should be unrolled and extended outside the printer cover.

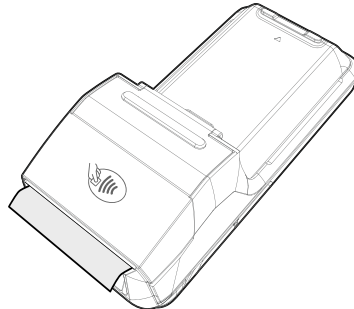

Install SD / SAM Card

1. Open the battery cover and take off the battery to reveal the card slots.

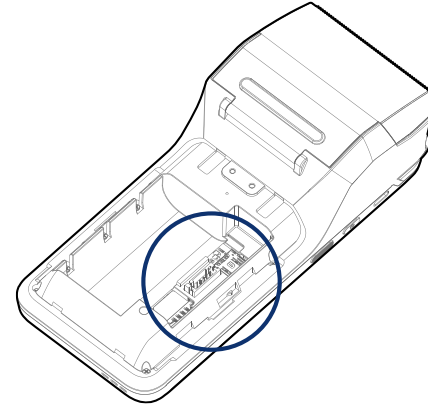

2. Insert the card into the proper card slot with the gold contact facing down.

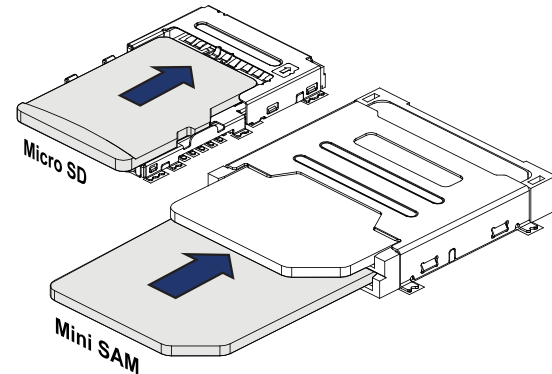

Turning on / off

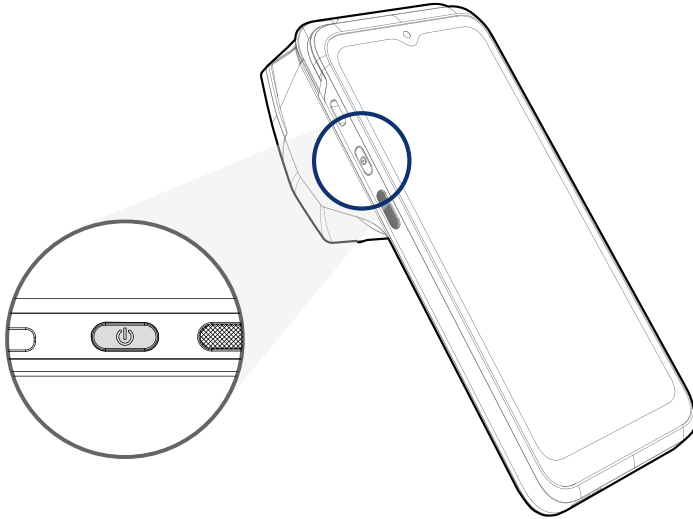

Turn on

Press and hold the power button on the left side of the P10 until the screen is turned on.

Turn off

When the display is on, press and hold the power button until the power menu is shown.

Then, tap **Power off**.

Charging the Device

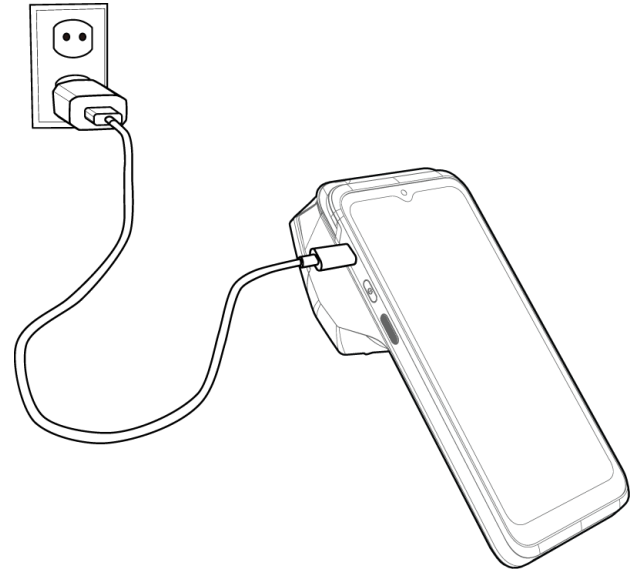

1. Plug the USB type C cable to the power adapter.
2. Connect the cable to the USB connector of the P10.
3. Provide power by plugging the power adapter to the wall socket.

< Caution >

1. *Always use an original power supply from Point Mobile. Other chargers and cables may damage the P10.
The device warranty does not cover any damage caused by the usage of non-original power supplies.*
2. *Make sure the charger and cable is not wet.*
3. *Charge in temperatures from 0°C to 45°C.*

Payment

Magnetic card

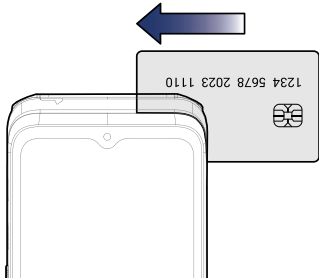

Swipe the card at a proper and steady speed.

Magnetic strip must be facing down.

IC card

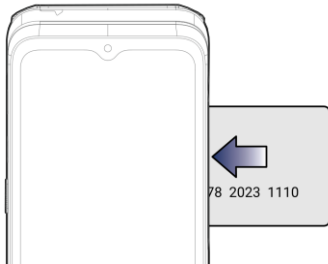

Insert the card and wait for completing the transaction.

IC chip must be facing up.

Contactless

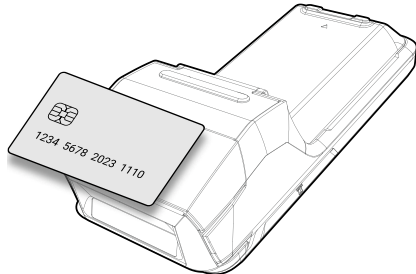

Bring the card close to the NFC logo on the printer cover.

Keep the position during the transaction.

Scan a Barcode

Scanner is equipped on the top of the P10.

Center the cross-hair aimer or red dot aimer over the barcode. You can tilt the aimer slightly for a comfortable angle to scan.

After aiming the barcode, scan the barcode using the scan button on the left side of the device.

